

State of Wyoming Corner Record

(In compliance with the CORNER PERPETUATION AND FILING ACT, Wyoming Statutes, 1977, Section 38-11-101, et. seq., and the Rules and Regulations of the Board of Registration for Professional Engineers and Professional Land Surveyors.)

Reverse side of this form may be used if more space is needed.

Record of original survey and citation of source of historical information (if corner is lost or obliterated). Description of corner monumentation evidence found and/or monument and accessories established to perpetuate the location of this corner. Sketch of relative location of monument, accessories, and reference points with course and distance to adjacent corner(s) (if determined in this survey). Method and rationale for reestablishment of lost or obliterated corner.

G.L.O. Record: Henry G. Hay, U.S. Deputy Surveyor, Nov. 6-12, 1873. Set a limestone 18 x 12 x 4 = 12 inches deep marked with 3 notches on the east side and 1 notch on the south side for corner to Sec's 27-28-33-34.

Subsequent Records: Laramie County Road No. 163, formerly Laramie County Road 92 (circa 1912). Laramie County Road No. 92 is described as following the section line.

Set: No. 6 x 30" rebar with 3 1/4" aluminum cap marked as noted below. The corner position was determined by single proportionate measurement between re-established corners north and south and maintaining the centerline of Laramie County Road No. 163 which was parallel with and 29' westerly of a old existing fenceline extending north. Monument was set approximately 8" below graded county road surface.

CAP MARKINGS

A.V.I. P.C.
T.17N.R.60W.

S28 | S27

S33 | S34

1995

P.L.S. 2927

LARAMIE COUNTY CLERK
CHEYENNE, WY.

'95 JUN 15 AM 10 16

163684

SEE ALSO RECORD OF SURVEY TO BE FILED IN LARAMIE COUNTY CLERKS OFFICE.

BOOK 1400

0474

Date of Field Work: April-Dec. 1994 Office Reference: A.V.I. Project No. 2-1847.94

CROSS INDEX DIAGRAM

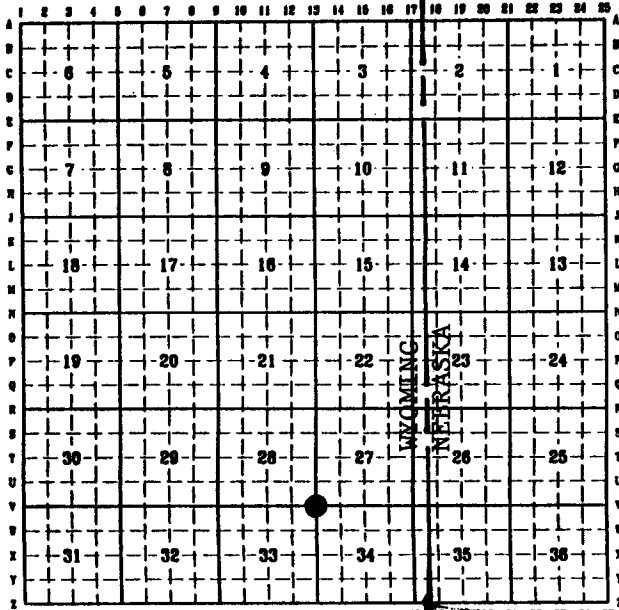

Firm/Agency, Address

PREPARED BY

Paul A. Reid, P.L.S.
A.V.I., P.C.
2035 Westland Road
Cheyenne, WY 82001

(307) 637-6017

This corner record was prepared by me or under my direction and supervision.

SEAL & SIGNATURE

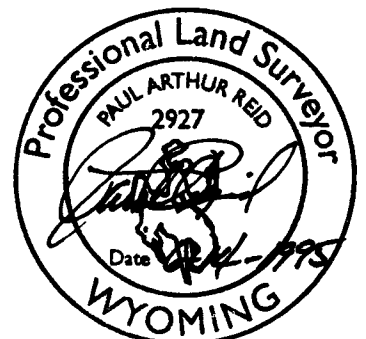

Corner Name: SE Corner

Section: 28 T 17N R 60W; 6th P.M. Cross-Index No.: V-13